

The TunnelTech 700 A low cost precision road & rail tunnel monitor using well proven technology providing accurate and rapid results.

The **TunnelTech 700** Air Quality Monitor, is an essential part of any road or rail tunnel safety system. Firstly, it monitors the atmosphere within the tunnel and ensures that the tunnel ventilation system provides sufficient clean air to protect tunnel user's health and for drivers to clearly see the road ahead.

The **TunnelTech 700** analyzer uses electrochemical cell technology to determine CO, NO & NO₂ concentrations, and optical attenuation to measure visibility levels. As there are no moving parts, reliability levels are very high and maintenance requirements are low. Visibility sight tubes are utilized to ensure that airborne dust and contaminants do not reach the optical windows and cause drift.

Features

- > Measure CO, NO, NO₂ & Visibility in one compact sensor
- > Advanced electrochemical cell technology
- > High resolution measurement
- > Minimal maintenance requirements
- > Available in 316 Stainless Steel



APPLICATIONS:

- > Rail Road Tunnels
- > Road Tunnels

System Layout Option 1 - Stand-alone systems

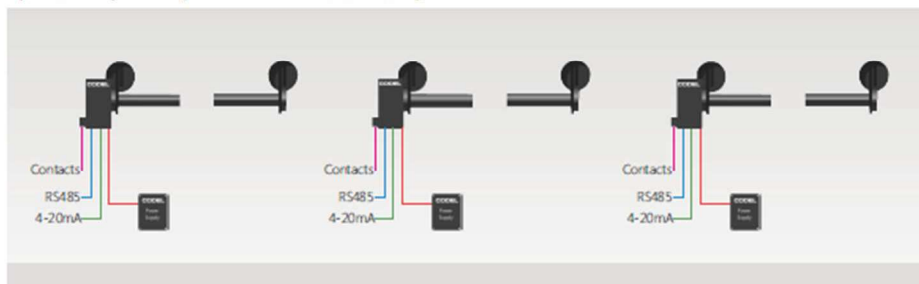

System Layout Option 2 - Integrated package

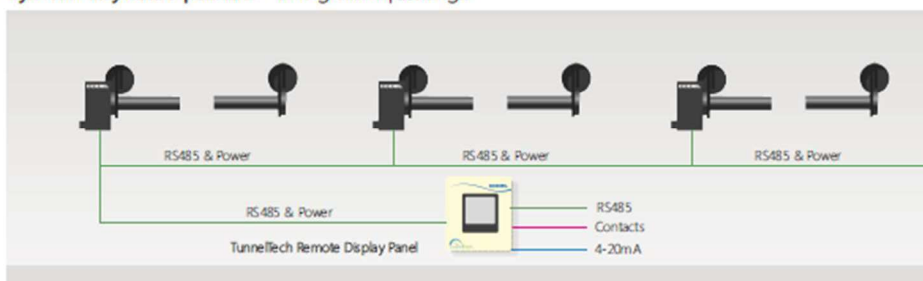

MONITORING SOLUTIONS

Complete source for all your Continuous Emissions Monitoring (CEMS) needs:

- > Both Dilution and Extraction CEMS systems
- > Data Acquisition Systems (DAS)
- > Flow Monitoring
- > Opacity Monitoring
- > Oxygen Monitoring Systems
- > Particulate (PM) Monitoring
- > Process Monitoring Systems

Sensor Unit

Measurement	Carbon Monoxide (CO) TunnelTech 701, 702, 703, 706,	Nitric Oxide (NO) TunnelTech 701, 702, 704, 707	Nitric Dioxide (NO ₂) TunnelTech 701, 705, 706, 707	Visibility TunnelTech 700 Series - all
Measurement Technique	Electrochemical Cell			LED Transmittivity
Measurement range (typical)	0 – 300 ppm	0 – 30 ppm	0 - 5/10 ppm	0 - 0.015 m ⁻¹
Accuracy	+/- 2 ppm or 2% span	+/- 2 ppm or 2% span	100 ppb	+/- 0.002 m ⁻¹
Resolution	+/- 1 ppm	1 ppm	5 0 ppb	+/- 0.001 m ⁻¹
Response Time	30 Seconds	30 Seconds	30 Seconds	10s - 2min Selectable

Ambient Temperature	-4°F to 122°F
Power supply	24V DC, 30 VA from separate power supply
Construction	- Corrosion resistant epoxy coated aluminum housing sealed to IP66 - Optional 316 Stainless Steel and 316 Stainless Steel TI for heads & Brackets
Calibration	Automatic zero calibration - manual span check
Path Length	3m (6m folded beam)
Measuring units	ppm for CO & NO, m ⁻¹ or m for visibility, ppb for NO ₂
Gas Species Options	Single or multi-gas measurements available: CO, NO ₂ , NO & Visibility

Customer Interface

Serial Data	Bi-directional RS485 MODBUS Protocol
Display	32 Character alpha-numeric back-lit LCD
Keypad	4-key soft-touch entry

Optional Items

Power Supply	90/264V AC, 47-63Hz, (24V DC @ 2.5A)
Tunnel Display Unit	For local display of sensors outputs
Analog Outputs	2 or 4 x 4-20mA current outputs as standard, isolated, 500Ω load max, fully configurable
Relay Outputs	2 or 4 volt-free SPCO contacts, 50V, 1A max, configurable as alarm contacts
Check Filter	Visibility span check optical cell available in different values
Span Check	NO, NO ₂ , CO span check using bottled audit gases

OFFICES

Philadelphia
E: jnowak@monsol.com
P: 908-500-4010

Indiana
4404 Guion Rd.
Indianapolis, IN 46254

Corporate
PO Box 520
Tatamy, PA 18085

Wyoming
9972 Landmark Lane
Casper, WY 82604